

Agriculture Building - Basement
Scale: None 02-04-09

GRANITE TILE -

CARPET -

RUBBER -

2"x2" CERAMIC
TILE -



Agriculture Building - First Floor
Scale: None 02-04-09

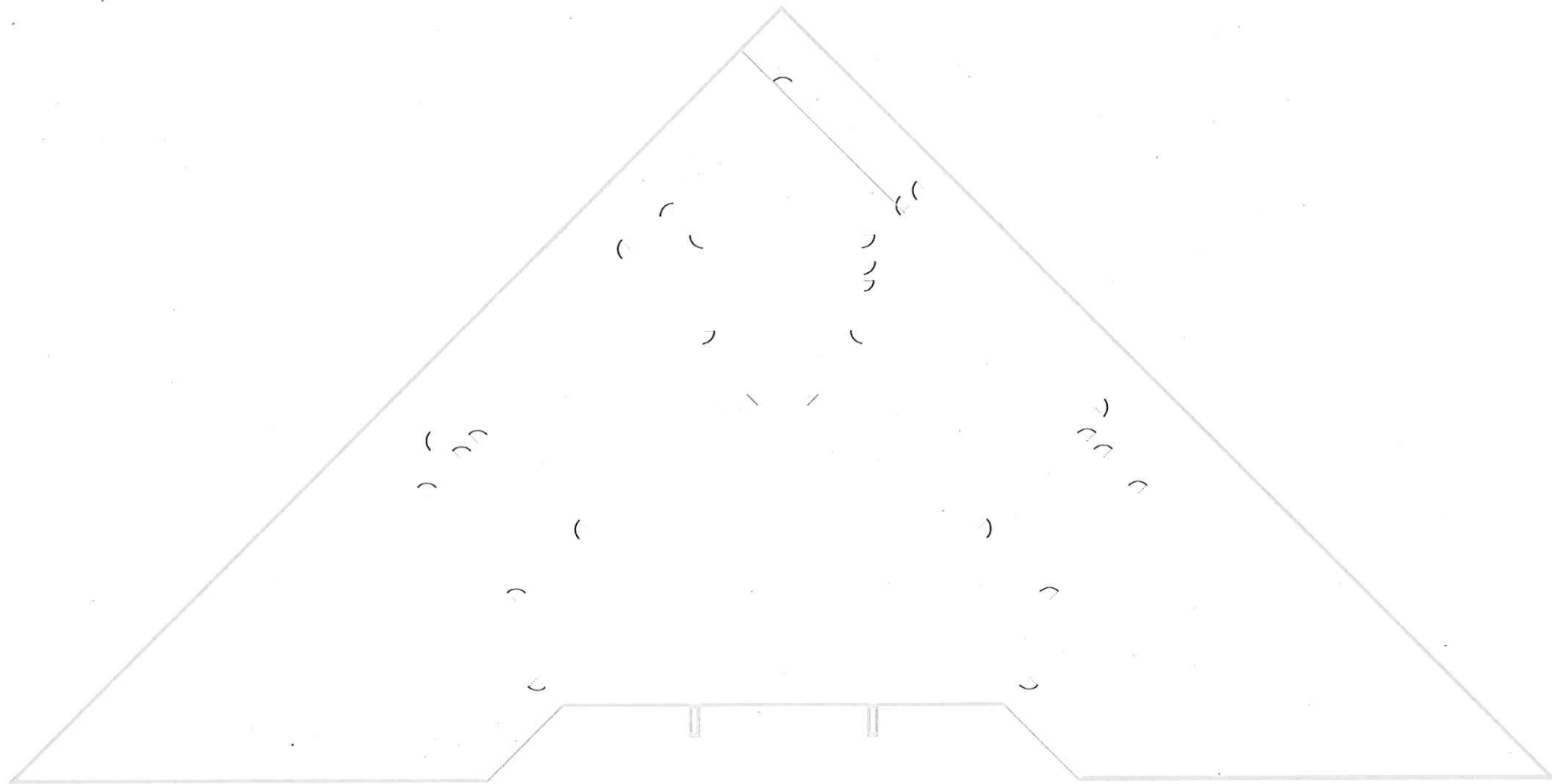

Agriculture Building - Second Floor
Scale: None 02-04-09

?

KEYNOTES

1. QSM#-LUTRON RF RECEIVER QSM2-4W-C. CIRCUIT AS INDICATED.

2. PJ#-LUTRON PICO WIRELESS DIMMER PJ-2BR-L-GWH-T01 (INCLUDE WALLPLATE AND WALLPLATE ADAPTER).

3. PS#-LUTRON WIRELESS PHOTOSENSOR LRF2-DCRB-WH.

4. OS#-LUTRON WIRELESS OCCUPANCY / VACANCY SENSOR LRF2-OCR2B-P-WH.

5. COVE MOUNTED FIXTURE. REFER TO ARCHITECTURAL DRAWINGS.

PLAN NOTES

A. LIGHTING AND LIGHTING CONTROL IS BASED ON LUTRON FIXTURES AND LUTRON QUANTUM TOTAL LIGHT MANAGEMENT. PRE-APPROVAL BY OWNER IS REQUIRED FOR ALL SUBSTITUTION REQUESTS. REFER TO SPECIFICATION SECTION 260943.

B. ALL LIGHTING CIRCUITS WEST OF THE MATCH LINE SHALL BE CIRCUITED TO EXISTING CIRCUIT BREAKERS IN PANEL HVP-3A.

C. ALL EXISTING EXIT LIGHTS SHALL BE REMOVED AND RETURNED TO BUILDING MANAGEMENT.

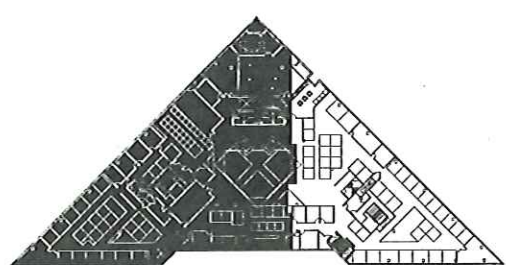

KEYPLAN

3rd Floor

RUBBER -

EPOXY FLOOR -

CARPET -

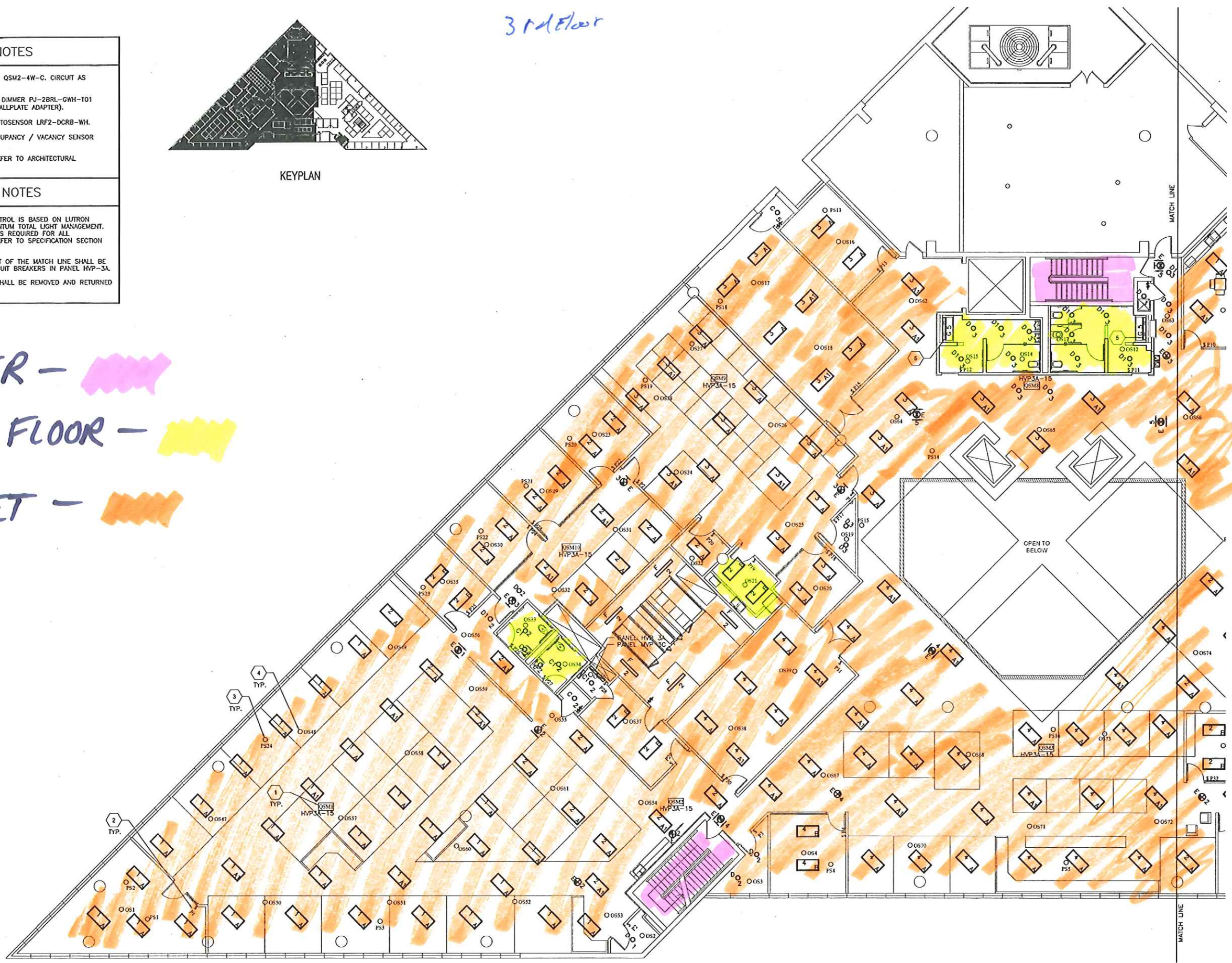

CYNERGY AEC
ARCHITECTURE - ENGINEERING - CONSTRUCTION
305 S. BOSTON, 12TH FLOOR, TULSA, OK 74103
918.577.8000 918.577.4000 FAX

PROFESSIONAL ENGINEER
CHRISTOPHER A. HARVELL
21109
5-4-14
OKLAHOMA
Cynergy AEC, Inc., PLLC
CA#3537
Expires 6/30/14
CHRISTOPHER A. HARVELL, P.E.
ENGINEER OF RECORD

PROJECT INFORMATION

PROJECT ADDRESS:
2800 N. LINCOLN BLVD.
OKLAHOMA CITY, OK 73105

PROJECT NO. OMES 14304

DATE 05-02-14

DRAWN BY BJ

CHECKED BY CAH

AGRICULTURE BUILDING
THIRD FLOOR RENOVATION
OKLAHOMA CITY, OKLAHOMA

ISSUE/REVISIONS

09/30/13 REVIEW SET

03/31/14 95% REVIEW SET

04/11/14 FIRE MARSHAL ISSUE

05/09/14 CONSTRUCTION ISSUE

A REMODEL PROJECT AT:
AGRICULTURE BUILDING
FOR:
OFFICE OF MANAGEMENT AND ENTERPRISE SERVICES

E101

LIGHTING PLAN

1 THIRD FLOOR WEST LIGHTING PLAN
SCALE: 1/8" = 1'-0"

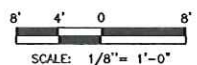

PLOTTED BY: Sub Javeli DATE: 04/25/14 3:21:21 PM DWG NAME: \Measurement of entire renovation-call map window_2013.dwg as 3d6g\revisions\drawings\new\2101.dwg
LAST SAVED BY: Javeli DATE: 04/25/14 3:20:53 PM

KEYNOTES
1. QSM#-LUTRON RF RECEIVER QSM2-4W-C. CIRCUIT AS INDICATED.
2. PJ#-LUTRON PICO WIRELESS DIMMER PJ-2BRLL-GWH-T01 (INCLUDE WALLPLATE AND WALLPLATE ADAPTER).
3. PS#-LUTRON WIRELESS PHOTOSENSOR LRF2-DCRB-WH.
4. OS#-LUTRON WIRELESS OCCUPANCY / VACANCY SENSOR LRF2-OCR2B-P-WH.
PLAN NOTES
A. LIGHTING AND LIGHTING CONTROL IS BASED ON LUTRON FIXTURES AND LUTRON QUANTUM TOTAL LIGHT MANAGEMENT. PRE-APPROVAL BY OWNER IS REQUIRED FOR ALL SUBSTITUTION REQUESTS. REFER TO SPECIFICATION SECTION 260943.
B. ALL LIGHTING CIRCUITS EAST OF THE MATCH LINE SHALL BE CIRCUITED TO EXISTING CIRCUIT BREAKERS IN PANEL HVP-3B.
C. ALL EXISTING EXIT LIGHTS SHALL BE REMOVED AND RETURNED TO BUILDING MANAGEMENT.



1 THIRD FLOOR EAST LIGHTING PLAN
SCALE: 1/8" = 1'-0"

8' 4' 0' 8'
SCALE: 1/8" = 1'-0"

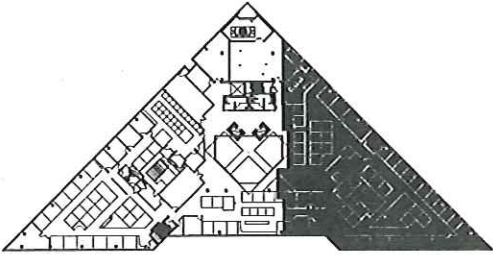

KEYPLAN

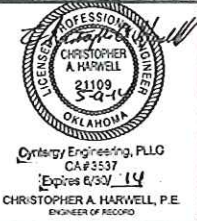

PROJECT INFORMATION
PROJECT ADDRESS:
2800 N LINCOLN BLVD.
OKLAHOMA CITY, OK 73105

PROJECT NO.	OMES 14304
DATE	05-09-14
DRAWN BY	CJH
CHECKED BY	CAH

AGRICULTURE BUILDING
THIRD FLOOR RENOVATION
OKLAHOMA CITY, OKLAHOMA

ISSUE/REVISIONS
09/30/13 REVIEW SET
03/31/14 95% REVIEW SET
04/11/14 FIRE MARSHAL ISSUE
05/09/14 CONSTRUCTION ISSUE

A REMODEL PROJECT AT:
AGRICULTURE BUILDING
FOR:
OFFICE OF
MANAGEMENT
AND ENTERPRISE
SERVICES

E102

LIGHTING PLAN

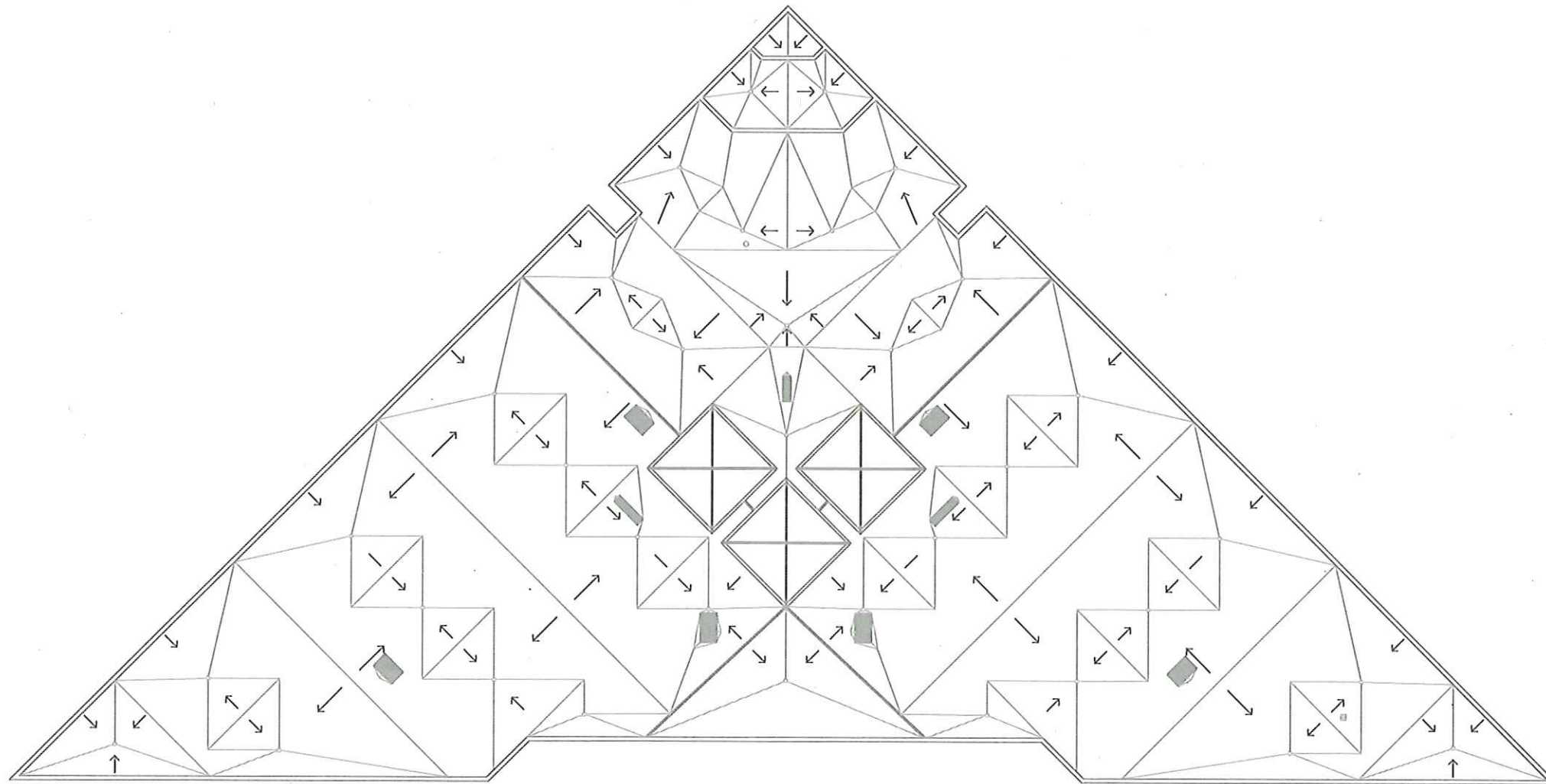

Agriculture Building - Roof Plan
Scale: None 02-04-09